

BAPTIST VILLAGE

SPRING/SUMMER 2016 MAGAZINE • A PUBLICATION OF BAPTIST VILLAGE COMMUNITIES • BAPTISTVILLAGE.ORG

Together We Serve



**CAPITAL FUNDRAISING CAMPAIGN WILL
BENEFIT EASTERN OKLAHOMA VILLAGES**

PAGE 4

contents

SPRING/SUMMER 2016

ON THE COVER

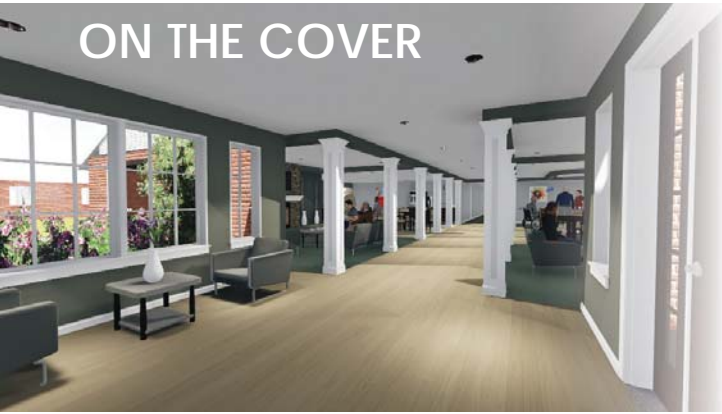

president's comments

3

EXPLORE THE BVC L.I.F.E. NETWORK® -
"A VILLAGE WITHOUT WALLS".



4 together we serve

CAPITAL FUNDRAISING CAMPAIGN WILL BENEFIT
EASTERN OKLAHOMA VILLAGES.

getting it done

6

MAE BELLE REED IS HAPPY TO DO WHATEVER
NEEDS TO BE DONE IN THE OWASSO DINING ROOM.

baptist village of elk city - out of the ashes

9

BVC IS PROUD TO CONTINUE THE WESTERN
OKLAHOMA DREAM.

8 tears of sadness replaced with tears of joy

YOU CAN SUPPORT BVC THROUGH YOUR GIFT.



2015 annual report

10

- FINANCIALS
- LEADERSHIP WINNER
- CHAPLAIN'S REPORT
- SOCIAL ACCOUNTABILITY
- DONORS

explore the bvc l.i.f.e. network[®] - "a village without walls"

DR. BILL PIERCE

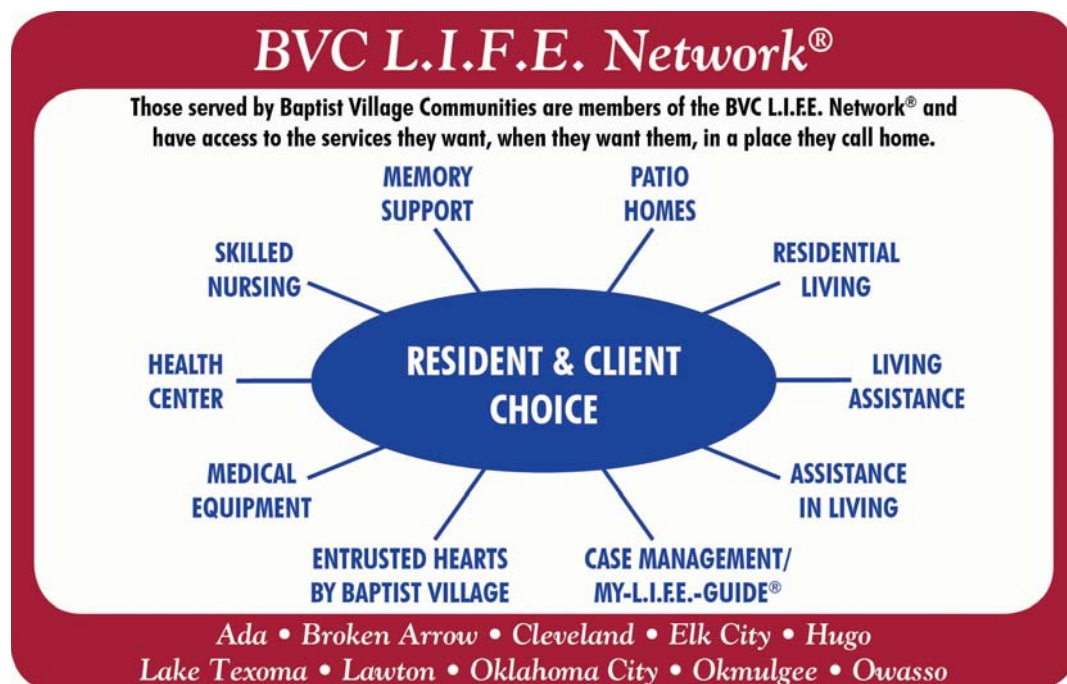

Discover the Baptist Village Communities (BVC) L.I.F.E. Network[®] of services. These are services people want, when they want them, in a place they call home.

People have a great opportunity to make choices regardless of where they live. Services are available on a BVC campus or in a city we serve. The BVC L.I.F.E. Network[®] is truly "a village without walls".

I love what each of the letters in the BVC L.I.F.E. Network[®] represent. They say everything about the way we see the privilege to serve others...

L.I.F.E.

- Living well
- Inspiring others
- Fulfilling dreams
- Exceeding expectations

Take a few moments to discover and explore the BVC L.I.F.E. Network[®]. Match your choices to the way you and your family want to be served in the place you call home.

Serving God,
Serving you,
Serving together.

Together We Serve

CAPITAL FUNDRAISING CAMPAIGN WILL BENEFIT EASTERN OKLAHOMA VILLAGES

Baptist Village Communities (BVC) is proud to be shaping the future of aging services in Oklahoma and beyond. To continue this tradition of excellence, BVC is excited to be planning considerable enhancements to five Baptist Villages in eastern Oklahoma.

Villages in Broken Arrow, Cleveland, Hugo, Okmulgee and Owasso will benefit greatly through the "Together We Serve" campaign.

"God has called many people to be a part of the BVC ministry," says Dr. Bill Pierce, BVC president. "We appreciate so very much those who give to enhance the lives of the people we serve."

BVC is happy to say that two of the capital projects are either completed or underway.

Thanks to the generosity of several individuals, the outdoor life enrichment venue at Baptist Village of Broken Arrow was completely paid for and is now finished. The venue was officially opened in April, hosting a cookout for Eagle Ridge patio home residents.

Additionally, the Sycamore Square neighborhood in Owasso now has a new name, Unity Square, and soon will feature a new look. A sizeable common area, café and living room is now under construction to be completed in the coming months.

The outdoor venue in Broken Arrow and Owasso's Unity Square renovation are the first in what BVC hopes is a lengthy list of enhancements throughout the five campuses. More updates on these projects will be coming soon.

ARTIST'S RENDERING OF COMING CAFÉ AREA IN UNITY SQUARE, BAPTIST VILLAGE OF OWASSO





ABOVE: THE NEWLY-COMPLETED OUTDOOR LIFE ENRICHMENT VENUE AT BAPTIST VILLAGE OF BROKEN ARROW



RIGHT: PATIO HOME RESIDENTS ENJOY A COOKOUT IN THE NEW VENUE, SITUATED INSIDE THE EAGLE RIDGE NEIGHBORHOOD.

Corky Eshelman, vice president of marketing and development, urges you to partner with us. "BVC has many opportunities to make cutting-edge changes that will enhance the lives of those we serve in creative and innovative ways. These can be accomplished if you will join us in investing to shape the future of aging services."

Personifying this caring spirit are the Thompson family, owners of Wynn Construction. Wynn has a long-standing partnership with BVC, and the Thompsons are gracious friends of Baptist Village Communities. The Thompson family has generously provided a major gift that will directly benefit the "Together We Serve" campaign. We are very excited as this gift provides some early momentum to the campaign.

There are many ways available for you to support this campaign. You can send a check to the development office - 3800 N. May Avenue, Oklahoma City, OK 73112. You also can donate on our website at www.baptistvillage.org.

Prayerfully consider your part in "Together We Serve". Thank you for your support! 

getting it done

OWASSO RESIDENT HAPPY TO DO WHATEVER NEEDS TO BE DONE IN THE DINING ROOM

The Redbud dining room at Baptist Village of Owasso is very organized and ready to go daily. This is due in large part to resident Mae Belle Reed.

The 88-year-old resident has been volunteering in the dining room consistently since moving to the Village nearly eight years ago.

"I moved to Baptist Village Communities in October 2008," says Reed. "It was not a long trip to move here. After moving from Tulsa, my late husband, Les, and I lived for 25 years just one mile away from the Village."

The Reeds moved to the Village due to her husband's health needs. After his passing, an apartment home was available for Mae Belle, and she has lived at the Village ever since.

It did not take long for her to get involved in Village life, particularly in the Redbud dining room. Her efforts have been noticed by many others on campus.

Chaplain Steve Williams says, "Mae Belle arrives around 9 am and works until about 12:30 pm. She does a great many things for the dining room. These include keeping the coffee made and hot, filling glasses with ice, cleaning the trays and working the register."

"She also refills the empty creamers, napkins, salt and pepper shakers and restocks the crackers. She restocks the cups, bowls and saucers for the salad bar. When needed, she will even dish the desserts like cobblers and ice cream. **Basically, she is willing to do anything that needs to be done.**"

Dining services volunteer Howard Cox concurs with Steve. "We simply couldn't get along without her."

When asked why Mae Belle does what she does, she responds, "I do it to stay active, and I love people. I get to see people I wouldn't otherwise get to see. Besides, It gives me the opportunity to say something encouraging to people. We have a lot of fun."

She continues, "Each resident has different wants and needs. We try to accommodate and work with them as best as possible. I am pleased to help. What you give gets returned to you."



**MAE BELLE REED WOULDN'T TRADE HER LIFE
AT BAPTIST VILLAGE FOR ANYTHING.**

Mae Belle certainly enjoys playing an instrumental role in the dining room. However, she adamantly insisted that others be given their fair share of credit, as well.

"I certainly am not alone. I'm a little embarrassed to be featured, as this truly is a team effort. My friend Darla on the dining services team plays a major role in prep. She works hard. There are also several volunteers besides me, including Donna, Ed and Sara. Even (Campus Director) Nathan Purifoy helps out in a pinch."

Reed enjoys not just dining room service, but Village life as a whole.

"What I like about Baptist Village life is the security. I feel very safe living here. I also love the people. The Friends Team members are very friendly, especially the kitchen team I work with daily. This is just home to me."

And Mae Belle has seen a lot of places. Her late husband's job as a Christian comedian meant they traveled all over Oklahoma and surrounding states. They even traveled to Florida and some places back east. When memory challenges forced Les to step down, they "retired" from the road.

But Mae Belle wouldn't trade her life at Baptist Village for anything.

"I feel like the Lord led me here. I tell all my friends about how great BVC is, too. I'm happy. This is where I want to be."

And Baptist Village of Owasso is thrilled to have this sweet-spirited lady. 

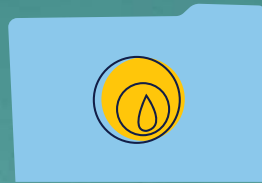

ONLINE ESTATE PLANNING IS HERE!

Estate planning is an essential step in preparing for the future and protecting your family. Through the Foundation, you can complete your estate plan entirely online.



Visit bfok.org/plan to learn more, and watch the Patterson family complete their estate plan!



THE BAPTIST FOUNDATION OF OKLAHOMA

tears of sadness replaced with tears of joy

YOU CAN SUPPORT BVC THROUGH YOUR GIFT

Baptist Village Communities (BVC) is blessed to have hundreds of people support BVC financially every year. Through this, we have been able to help countless residents and Friends Team members in many ways.

The "I Give" program encourages Friends Team members and residents to provide support to the Adams Assistance Fund. The Adams Fund provides assistance to residents with financial challenges.

Baptist Village has promoted giving to the Adams Fund as part of our I Give program the last four years. The program has seen a radical jump in Friends Team members giving, from about 35 when the program started to now more than 275 givers.

Terry Dennis, campus director at Baptist Village of Cleveland, gives to the Adams Fund. "For nearly 13 years, I have had the pleasure of sharing good news with older adults. These individuals want to live at Baptist Village, but can't because of limited income. I love to be able to tell them, 'yes, you can enjoy all the blessings of living here because friends of BVC give to the Adams Fund.'"

"Many times, I get to see tears of sadness replaced with tears of joy. Friends they likely will never meet have given from their heart to make living at the Village possible."

Baptist Village also has exceptional financial support from its Board members. Long-time Board member and former chairman of the Board, Paul Abbott, explains why he and his wife, Betty, support BVC and the Adams Fund.

"Betty and I give to the Adams Fund because we believe it is the right thing to do. We want to be obedient to God in all that we do. God's Word instructs us to take care of the widows and those that are in need. So many have given their lives so unselfishly to His work, and now they need help in their later years. We count it a privilege and honor to be able to contribute to this Fund."



Finally, BVC is thrilled to have residents who give. Baptist Village of Oklahoma City resident Thelma Clark eagerly shares what the Adams Fund means to her.

"When my husband and I first moved to Baptist Village in 2007, we had heard about the Adams Assistance Fund and how it was being used to assist those in need to be able to live at Baptist Village. So we asked a neighbor friend of ours, and she said it was a very worthy cause and she would highly recommend giving to this Fund. So right then, we budgeted an amount of money for the Fund and have been giving ever since. We have nothing but praise on how the Fund is being used."

"I know there are so many who cannot afford to live at Baptist Village, and we wanted to help. I receive a report each year of how the Fund is being used and how others are being helped. The Home Office is always so nice in informing us how the Fund is helping others, and we are glad to be a part of it."

The Adams Fund provided \$22,000 in assistance in 2000. Last year, BVC provided assistance to the tune of \$559,000. That is an average increase of more than \$35,000 a year, and this need is constantly growing. With the Adams Fund's current rate of assistance, it will be very challenging to keep up with the growing demand.

Baptist Village Communities is strongly encouraging Friends Team, residents, Board members, support team members, and you to consider giving to the Adams Assistance Fund.

There are many ways to give monetarily. One of the easiest ways to do so is on our website at www.baptistvillage.org. You also are more than welcome to give to Baptist Village via cash or check. These gifts can be mailed to the Baptist Village Development Office: 3800 N. May Avenue, Oklahoma City, OK 73112. 

BAPTIST VILLAGE OF ELK CITY - OUT OF THE ASHES

BVC IS PROUD TO CONTINUE THE WESTERN OKLAHOMA DREAM

Baptist Village Communities (BVC) experienced a tragedy on September 15, 2015, as our assistance in living building under construction in Elk City burned to the ground. The outpouring of support following the event from local fire departments, first responders, Baptist Disaster Relief and Elk City, First was an incredible blessing.

We are pleased that God brings new things out ashes, as work is moving forward on the rebuild.

"The Neighborhoods at Baptist Village of Elk City are progressing very well," says Wendell Short, vice president of planning and project management. "It still stirs up a mixed sense of emotions as I head that direction to view the progress, but it is great to see framing, roofing and interior work coming together."

He continues, "Elk City is an outstanding community and will be a great place for BVC to serve. The construction crews are blessed by the homemade cookies and goodies provided by the ladies of Elk City, First."

BVC anticipates the building being complete in late 2016. Thank you for your continued support and prayers! 





Baptist Village
Communities

**ANNUAL
REPORT
2015**



board of directors

BAPTIST VILLAGE COMMUNITIES

“Work hard so you can present yourself to God and receive his approval. Be a good worker, one who does not need to be ashamed and who correctly explains the word of truth.”

2 Timothy 2:15 (NLT)



BOARD OFFICERS 2015-2016

Left to right: Dr. Dennis Curtis, Hugo, First Vice Chairperson;
Dr. Bill Pierce, BVC President; Danny Ringer, Elk City, Chairperson.
Not pictured: Eddie Miller, Sand Springs, Second Vice Chairperson.



BOARD OF DIRECTORS AND ADVISORS 2015-2016

First row: Dawn Ann Mendenhall, Fairview; Sheri Carter, Poteau; Dr. Dennis Curtis, Hugo; Danny Ringer, Elk City; Dr. Bill Pierce; Paul Abbott, Jenks (Advisor); Shirley Penick, Tulsa; Peggy Clark, Ada; Marty Morrow, Hobart. Second row: Walter Mullican, Oklahoma City; Dennis Dawson, Lawton; Susan Mullins, Norman; Jim Sheetz, Bartlesville; Ruth Walker, Tecumseh; Joey Newton, Okmulgee; Karen Myers, Edmond; Don Harkey, Broken Bow; Linda Gibbs, Holdenville. Third row: Luke Kannady, Kingfisher; Dr. Dennis Taylor, Okmulgee; Kerry Russell, BGCO (Advisor); Ben White, Yukon; Bud Evans, Tulsa (Advisor); Clint Hart, Walters; Matt Trentham, Leedey; Don Ethridge, Cushing; George Gibbs, Tulsa (Advisor). Not pictured: Mark Gandy, Edmond (Advisor), Dr. Anthony Jordan, BGCO, Jim Lee, Edmond; Eddie Miller, Sand Springs; Greg Platt, Ardmore.

financials 2015

BAPTIST VILLAGE COMMUNITIES

“Wherever your treasure is, there the desires of your heart will also be.”

Matthew 6:21 (NLT)

Total Assets
\$80,156,959

Total Liabilities
\$30,820,210

Total Contributions
\$3,986,996

Total Revenue and Other Support
\$40,497,649

Total Expenses
\$40,305,163

Total Investment and Endowment Income
\$658,092



Baptist Village Communities (BVC) leads the way in shaping the future of aging services. BVC has many ways that you can help support BVC’s ministry.

The Larry and Edwine Adams Assistance Fund helps those with financial challenges to live at Baptist Village. This very important Fund is solely supported by gifts from Friend Team members, residents and friends like you.

The annual Mothers Day Offering is a Baptist General Convention of Oklahoma offering. The offering benefits both Oklahoma Baptist Homes for Children and BVC. One-hundred percent of BVC’s portion goes directly the Adams Fund.

Finally, you can support the ministry of BVC through an estate gift. Estate gifts are an opportunity to ensure that financial support will remain readily available for the future.

For more information on how you can partner in ministry with BVC, call the development office today at (405) 942-3000 ext. 4205. You also can donate to BVC online at www.baptistvillage.org.

WWW.BAPTISTVILLAGE.ORG

LeadingAge continues to honor Baptist Village

CRISTELLIS NAMED NON-RESIDENT VOLUNTEERS OF THE YEAR

"In the same way, let your good deeds shine out for all to see, so that everyone will praise your heavenly Father."

Matthew 5:16 (NLT)

Baptist Village Communities (BVC) is glad to say that Pat and Dee Cristelli were named non-resident volunteers of the year by LeadingAge Oklahoma, the state association of not-for-profit senior living organizations.

Pat and Dee serve at Baptist Village of Ada. They began this journey when Dee's mother Mary, Proverbs Park at Baptist Village of Ada's first resident, moved to the Village. Upon her arrival, Pat and Dee became regular fixtures on campus.

The Cristellis go with residents on walks, help with life enrichment events and encourage the residents and Friends Team members. They also organize holiday parties for the entire Proverbs Park family. These parties are planned for all holidays, not just Christmas and Thanksgiving. "Family parties" and celebrations for big sports events are scheduled when there are no holidays in the near future.

Pat and Dee are involved with the daily life at Baptist Village of Ada, as well. They participated in the life enrichment "beach week" theme and helped the residents do so, as well. During their visits, they play cards, discuss ideas for events and more.



DEE AND PAT CRISTELLI

The Cristellis regularly bring along their dog, Peepers, to visit the residents. Residents look forward to these visits and often ask about him when he doesn't join his owners.

Not only do Pat and Dee give so generously of their time, but they also are financially generous. When Dee heard about a need that arose, she jumped into action. A resident needed a better vacuum, so Dee simply purchased one at her own expense and donated it.

With their time, encouragement and financial support, Pat and Dee Cristelli help make Baptist Village of Ada a homelike and special family place for all residents.

BVC is thrilled to congratulate this special couple on this very deserving honor.



chaplains ministry report 2015

“So encourage each other and build each other up, just as you are already doing.”

1 Thessalonians 5:11 (NLT)

Baptist Village Communities (BVC) has the privilege and joy of placing a chaplain in every Village to coordinate ministry with residents, clients, families and Friends Team members. Many of the chaplains are volunteers.

Each chaplain is challenged to enhance ministry by organizing residents into teams and equipping them for service. It is rewarding to see residents exercising their own unique spiritual gifts and talents, ministering to one another and Friends Team members. The Village chaplains and ministry teams reported the following results from their combined efforts in 2015:



THE GOSPEL WAS PRESENTED...

- 2,164 opportunities for worship and Bible study
- 1,919 spiritual resources distributed

LIVES WERE CHANGED...

- 123 affirmations/rededications
- 9 professions of faith
- 6 baptisms

RELATIONSHIPS WERE CULTIVATED...

- 12,298 resident/client visits
- 3,417 Friends Team visits
- 751 family visits
- 750 Rehab guest visits
- 497 churches participated in ministry

ENCOURAGEMENT WAS OFFERED...

- 20,076 resident ministry team visits
- 580 hospital visits or calls to residents

CAMPUS LIFE WAS ENHANCED...

- Resident newcomer fellowships
- Resident ministry teams
- Revivals/VBS/Holy Week
- Lunch and learn presentations
- Summer youth projects
- Choirs and bell ringers
- Festivals and concerts
- Family consultations
- Intercessory prayer ministry
- Spanish language ministry



LINC[®] (Loving, Inspiring, Nurturing, Caring) is a ministry of BVC, designed to equip churches to develop a vibrant ministry to elders in senior living communities by providing training, resources and ministry tools. A LINC[®] consultant works with senior living community team members to open doors of ministry and tailor it to meet residents' specific needs. The goal of LINC[®] is to give every Oklahoma Southern Baptist church the opportunity and knowledge to extend its current ministry in the community.

For more information on LINC[®] and other chaplaincy ministries, contact Chris Finley, director of chaplain services, at (405) 470-8915 or cfinley@okc.baptistvillage.org. We give God the glory for the good work of the chaplains and ministry teams in reaching out and enhancing lives of those being served.

social accountability 2015

“And don’t forget to do good and to share with those in need. These are the sacrifices that please God.”

Hebrews 13:16 (NLT)

Opportunities to provide community services are multiplied every day throughout Baptist Village Communities (BVC). They are the natural activities of our organization, whose mission is to honor God by creating communities and services to enhance lives and enable people to serve God and one another. These services help meet unmet needs in communities.

Since its founding 58 years ago in 1958, we have grown to include eight Villages, three home health agencies and a medical equipment company. The number of people ministered to daily has grown from 1,150 in 1993 to more than 2,200 in 2015 - a 91 percent increase.

The social accountability report allows you to understand how BVC impacted its surrounding communities, providing charitable services in the towns and cities BVC serves.

Annually, we document our social accountability. Campus directors record their charitable services and community programs. In 2015, BVC provided benefits to residents, Friends Team members and the surrounding areas.

BVC also provides outright benevolence to residents who need financial assistance. Along with the generosity of Friends Team members and other residents, financial needs are being met. Senior adults, families and children are assisted with basic needs, such as provision of food, health services and housing.



Meeting community needs includes, but is not limited to:

- Caregivers supporting the elderly in the community
- Elderly living alone or with few social opportunities
- Homebound senior adults having difficulty with daily living activities
- Widows and couples with limited resources and income
- People in need of services they may otherwise be unable to receive

Using the Adams Assistance Fund to assist with monthly service fees, we gave out more than \$559,000 last year. Those assisted through this Fund are residents who, without it, would be unable to meet their monthly expenses.

The Friends Teams and residents of several Villages have participated and volunteered their time to help with free home health services. They provide services for residents receiving Medicaid, where there is a shortfall in reimbursement.

BVC provided charitable services to their broader communities by meeting financial, health and community needs - serving 5,775 people with a value of \$2,777,682.57.

In 2015, BVC provided hundreds of services in Oklahoma communities. These needs were met by providing the following services, among others:

- Angel trees
- Christmas cantata
- Christmas shoe box ministry
- Clinical site for nursing students
- Community craft night
- Emergency responders banquet host
- Food baskets for needy families
- Halloween fun treat night host
- Jewelry cleaning
- Memorial books for residents
- Pie and praise event
- School supplies for needy families
- See You at the Pole
- Servants of Hope Alzheimers Support Group host
- Tai chi fitness classes
- Tax preparation services
- Volunteer appreciation lunches
- Voting precinct site



CHECK OUT THE BAPTIST VILLAGE WEBSITE!

WWW.BAPTISTVILLAGE.ORG

HOME CONTACT US

Baptist Village Communities

Locations Entrusted Hearts Giving Online Medical Equipment LINC® Rental Assistance Donate

donors

BAPTIST VILLAGE IS GRATEFUL FOR YOUR GENEROSITY IN 2015!

LEGACY PARTNERS

(\$50,000+ LIFETIME)

Abbott Industries, Inc.
Paul and Betty Abbott
Baptist General Convention of
Oklahoma
Beckham-Mills Baptist Association
Bryant Family Trust
Lucille Copeland
Covington Aircraft
Verda Julia Denning Trust
Paul and Ruth Dickinson Trust
Bud and Joyce Evans
Mamie Farnham
Geneva Farris
Chris and Shari Finley
George and Rachel Gibbs
Franklin Gustafson Endowment Trust
Bert and Sue Hutson
Greta Ivey
Mary Lou Kiser
LuGreg Trucking, Inc.
Jean Lynch Estate
Ed Ben McCollough Estate
Vonna Sue Milburn Estate
Fannie Mombie (D)
Grace K. Newberry Estate
Oklahoma City Community Foundation
Thomas Peery (D)
Raymond and Shirley Penick
Pauline Prophet Irrevocable Trust
Mary Louise Smith Estate
Southern Hills Baptist Church,
Oklahoma City
Bill and Kay Stiles
William F. and Veda Boyd Terry
Revocable Trust
Richard and Patty Thompson
Rick and Lisa Thompson
Tim and Sue Winters
Wynn Construction
R.A. Young (D)

PARTNERS IN EXCELLENCE

(\$5,000+ ANNUALLY)

Paul and Betty Abbott
Beckham-Mills Baptist Association
Paul and Ruth Dickinson Trust
Lois Eshelman
Bud and Joyce Evans
George and Rachel Gibbs
Jewel Graham Revocable Trust
Harold Griffith Estate
Randy and Kim Ice
LuGreg Trucking, Inc.
Myrl and Jean Lynch Estate
Alvin and Glenda Mackey
Sue Medcalf

Oklahoma City Community Foundation
Raymond and Shirley Penick
Greg and Mary Robbins
Mary Louise Smith Estate
Bill and Kay Stiles
Rick and Lisa Thompson
Rusty and Syndy Thrash

PRESIDENTIAL PARTNERS

(\$1,000-\$4,999 ANNUALLY)

Larry and Edwine Adams
Donna Antosh
Bobbie Sue and Dwayne Baker
Jim and Michelle Billings
Edward and Keri Bivins
Jeff and Alison Boyd
William Bridges
Michael and Michelle Brown
Loren Burger
Dennis and Sheri Carter
Thelma Clark
Council Road Baptist Church,
Oklahoma City
Grant and Kay Crews
Margaret Dalton
Terry and Sherry Dennis
Corky and Darla Eshelman
Geneva Farris
Chris and Shari Finley
First Baptist Church, Blair
First Baptist Church, Lawton
First Baptist Church, Weatherford
E.L. and Wilma Fowler
John and Linda Gibbs
Martin and Jill Hall
Luke and Bert Kannady
Jack David Kelley and Mary Ethel
Kelley Estate
Robert and Tonia Kellogg
LAC Oil and Gas Inc.
Kyle Lackey
Liberty Baptist Church, Morris
Carol McCain
David and Barbara Merrill
Ken and Dana Mills
Virginia Mayo Ownby
Joan Pace
Edmond Packwood Endowment Trust
John and Teresa Petersen
Bill and Susan Pierce
Kyle and Sherri Powell
Quail Springs Baptist Church,
Oklahoma City
Glenda Redden
Mike and Debbie Ross
James and Nancie Rosson
Van and Pat Schallenberg
Wendell and Teresa Short
Springhill Baptist Church, Howe

Dolores Taylor
Steve and Billie Thomas

CARING PARTNERS

(\$500-\$999 ANNUALLY)

Ty and Christine Bell
Frances K. Burrow
Charles and Lois Caillouette
Calvary Chapel, Oklahoma City
Troy and Kimberly Caudle
David and Patricia Childs
Chisholm Heights Baptist Church,
Mustang
College Heights Baptist Church,
Chickasha
Lester and Metta Ruth Craft
Don and Mickey Cravens
Dennis and Misty Curtis
First Baptist Church, Broken Arrow
First Baptist Church, Dougherty
Gems of Wisdom Sunday School Class
Thomas Gray
Don and Kay Harkey
Randy and Linda Harris
Jimmie Hazelbaker
Evertt Hollingshead
Jeff and Judy Hughes
Patsy Keith
Mark and Arvella McCollom
David and Barbara Meyerhoeffer
Tolly Miller
Jim and Marty Morrow
Delphine Nkwain
Oklahoma Foundation for Medical
Quality, Inc.
Park Place Baptist Church, Cushing
Kevin and Shannon Ryan
Tracy and Carolyn Scheer
Southpark Baptist Church, Oklahoma
City
Frieda Stewart
Kendall and Deborah Suiter
Trinity Baptist Church, Pauls Valley
Jerry and Judy Unruh
Suzanne Walette
Randy and Julie Weatherford
Westport Baptist Church, Cleveland
Larry Wright

PARTNERS

(\$100-\$499 ANNUALLY)

Susan Abbott
Sid Adkinson
Tambra Alexander
Angelo James Amendola
Patricia Ayers
Rosa Babb
Judy Babcock
Barbara Baker
Clay and Julia Baker
Baptist Village of Owasso Choir
Paul Bauman
Kevin Bell

Ralph and Vivian Boyle
Nisa Bradley
Pamela Branton
Deborah Brost
Gary and Ramona Brown
Oren and Betty Brown
Cheryl Lynn Bryant
Buddy Bureson
Jackelin Chastain
Cherry Tree Baptist Church, Stilwell
Dillon and Jessica Chilcoat
First Baptist Church, Choctaw
Charles and Charlene Clark
Peggy Clark
Rachelle Clay
Amanda Cook
Shannon Coomer
Cloyd Cornish
Cottonwood Baptist Church, Coalgate
Dorothy Crane
Ed Crane
Ashley Crittenden
Amanda Crowell
Ralph and Sandra Cunningham
Bobby Dan (D)
Scott and Tina Davis
John and Cathy Dorough
Mitzi Epperson
Don and Mary Ann Ethridge
Claude and Sally Farris
First Baptist Church, Hominy
First Baptist Church, Moore
First Baptist Church, Mounds
First Baptist Church, Pauls Valley
First Baptist Church, Pond Creek
Evelyn Fomune
Nancy Fowler
Bill and Martha Fuller
Galey Baptist Church, Stratford
Mark and Laura Gandy
Angel Garman-Smith
Bobby and Debbi Ghere
Hannah Goodspeed
Maryann Grasich
Martha Grunau
Twilah Hampton
Andrew Hansen
Clint and Sandra Hart
Robert Haskins
James and Stephanie Hastings
Anita Hatch
Marjorie Hatcher
David and Kathy Lee Hatchett
Blanche Hazelbaker
Ashley Heady
Viva Henley
Barbara Henry
John and Cheryl Herndon
Eric and Azure Herrera
Anna Holland
Twylah Horne
Gary Houk
Judy Ingle
A.L. and S.T. Ingram
Kim Inman
Chris and Anna Jackson
Tia Jefferson

Lenora Johnson
Oscar Keith
Mary Lou Kiser
Andrea Kreis
Bill and Lea La Rue
Johnetta Lane-Williams
Danielle Langston
Jim and Dianne Lee
MaryAnn Leiia
Darlene Lewis
Mary Lewis
Marcia Loeffler
Darlene Logsdon
Bonnie Lohman
Whitney Mandrigues
Rick and Shannon Mangrum
Margaret Manley
Maramec Baptist Church, Maramec
Stan and Jeanne Martin
Junetta McCaslin
Craig and Janice McCleery
Minnie McDaniel
Alice Marie Meek
David and Dawn Ann Mendenhall
Roy and Lynne Merrill
Sherry Miller
Gale Movo
John and Ann Mowery
Rose Muli
Walter and Kathy Mullican
Garell Murray
Shaniquia Nash
John Ndeh-Zama
Joey and Jackie Newton
Gary and Ann Ormston
Rita Paredes
Cathy Patton
Charles and Gloria Peck
Mary Pena
Beatrice Peters
Pharmacy Solutions LLC
Lee and JoAnn Piatt
Donna Planchon
Kelly Pruitt
Clarice Pugh
Nathan and Jamie Purifoy
Vicki Randolph
Dot Ray
Julie Regan
Jacqueline Rife
Danny and Penny Ringer
Susan Rooker
Jessica Roper
Berniece Sauls
Marjorie Schaeffer
Wanda Sellers
Leon and Carol Shade
Jim and Linda Sheetz
Bebie Shelton
Deborah Shiner
Larry and Muriel Siegenthaler
Tom Slamans
Tessa Smith
Jeanine Soard
Robertta Sonnier
South Tulsa Baptist Church, Tulsa
Dan Stiles

Jacqueline Stolz
Holly Stewart
JoAnn Sweet
Dennis and Janet Taylor
Cole Thomason
Mechele Thorpe
Londa Tipton
Amy Tointigh
Matt and Antoinette Trentham
True Love Baptist Church, Spencer
Weeta Tucker
Leah Turley
James and Jennifer Ulmer
Tiara Varner
Carla Venable
Jerry and Ruth Walker
Joy Wellington
Western Heights Baptist Church,
Cleveland
Roy Wilburn
Allie Wilhelm
Steven Williams
Tiffany Willis
Elaine Wilson
Jennie Wolek

FRIENDS (\$1-\$99 ANNUALLY)

Joel Abrahams
Elizabeth Allensworth
AT&T Employee Giving/United Way
Campaign
Jennifer Atkeson
Ava Baggett
Tracy Bates
Beverly Battiest
Ella Beall
Tykela Beard
Sebrina Bell
Berean Baptist Church, Tulsa
Barbara Berlien
Jay and Terri Bidwell
Eula Mae Bishop
Jerry and Cindy Boling
Joyce Bolton
Sara Boyzo
Suzanna Bradley
Connie Brandes
Jennifer Branson
Grady and Frankie Brewer
Jeannette Brewer
Britton Baptist Church, Oklahoma City
Tammy Broam
Charles and Carolyn Brown
Robynn Brown
Shelly Brown-Davis
Melva Burks
Deanna Burns
Ellen Campbell
Shirley Cannon
Cassie Carlile
Dorothy Carter
Harvey and Sandy Carter
Tara Chambers
Lizzie Chansa

Ashley Coffelt
Buddy and Karen Collins
Melvin and Nancy Collins
Virginia Collins
Curtis and Kim Cooksey
Charlotte Cooper
Kelsey Crabtree
Bryelynn Crenshaw
Barbara Crockett
Delores Cummins
Rosana Damron
Stephen and Anne Davidson
Jason and Jennifer Davis
Denise Davis
Maria DeLoera
Gary and Sheila Dempsey
Hazel Dodrill
Shelly Edwins
Amanda Ennis
Michael Feemster
Ashley Finley
First Baptist Church, Boise City
First Baptist Church, Boynton
First Baptist Church, Calera
First Baptist Church, Faxon
First Baptist Church, Soper
Mary Fite
Virginia Flaming
Virginia Fraser
Linda Friggel
Raymond Gonzales
Harley and Alice Gosney
Grace and Truth Baptist Church,
Oklahoma City
Keri Gray
Crishon Green
Elisha Green
Martha Greer
Gene and Kay Hadley
Cynthia Hall
Dana Hall
Hanna Baptist Church, Hanna
Barry and Donna Harvey
Sally Hayhurst
Cecilia Hernandez
Harli Hevron
Courtney Hobgood
Christi Holliday
Billy Hopkins
Marie Houk
Mary Houston
Donna Hubbard
Bobby and Jane Hubbell
Nicole Hull
Gwendolynn Hummingbird
Patricia Issa
Stephanie Jenkins
Donna Johnson
Ruth Jones
Wilma Jones
Stephanie Kerby
Troy Knight
Jessie Koponen
Charles and Velma Jean Krumtum
Bertherine Kubia
Floyd Edward Kucinski
Brandy Lamoni

Debbie Landaverde-Perez
Tamera Lee
Jimmy Lehev
Amiko Lester
Cherie Lewis
Kimberly Lindsey
Jeannine Long
Christina Looney
Brittany Love
Tammy Lundry
Debbie Lynch
Laura Mackey
Theresa Ann Maderer
Ruby Mangrum
Many Springs Indian Baptist Church,
Holdenville
Maria Marruto
Anesha Mason
Maybelle Baptist Church, Welch
Sally McCoy
Amailee McElhany
Patricia Lynn McGuire
Cloyce and Carol McKee
Mark and Sherry McLeod
Krystle McNeal
Betty McNeil
Paula Means
Samantha Messer
Lawrence Middleton
Eddie and Kendyll Miller
Katja Miller
Larri Miller
LaWanda Miller
Lisa Miller
Jaela Mims
Greg Mitchell
Denise Mobley
Brittany Moody
Sara Morales
Scott and Sharon Morie
Francisca Mukete
Steve and Susan Mullins
Thomas and Barbara Murphy
Cheryl Musgrove
Susan Natt
Network for Good
New Harmony Baptist Church,
Bartlesville
Emory and Beverly Newberry
Cindy Norton
Alfred Nye
Taylor O'Connor
Debra Officer
Oney Baptist Church, Albert
Kelley Opela
Maria Ordonez
Elizabeth Oridota
Beverly Osburn
Viki Owens
Jacqueline Pacheco
Robert Perez
Pilgrims Rest Baptist Church, Valliant
Annette Pound
Martha Pratt
Candice Pugh
Rancho Village Baptist Church,
Oklahoma City

Scarlet Ratliff
Connie Ratzlaff
Darwin Rea
Rebecca Reeves
Adriana Rico De Luna
Yvonne Riggs
Shaloye Robinson
Shari Roebuck
Cora Rogers
Keith Rogers
Britney Romero
Elizabeth Romo
Roses of OK Red Hat Society
Brian Russell
Sallateeska Baptist Church, Shawnee
Shelby Sandusky
Tricia Santillan
Shield of Faith Baptist Church,
Catoosa
Lorna Shirley
Priscilla Simpson
Roneshia Sloan
Pamela Smith
Rhonda Sneed
South Rock Creek Baptist Church, Red
Oak
St. Andrews United Methodist Church,
Oklahoma City
Sarah Standeford
Larry and Patricia Standiford
Shaniece Starks
Nadia Steinbeiser
Wyvonna Strigglers
Dennis and Carolyn Tate
Haily Terry
Amanda Townsend
April Trammel
Connie Triggs
True Light Baptist Church, Oklahoma
City
Loren Turner
Helen Upchurch
Virginia Vankleef
Trish Velazquez
Marcia Versey
Robert and Mary West
Leonard and Lodema Whisenhunt
Ben and Sue White
Luther Whitlow
Benjamin Williams
Kimberly Williams
Terry and Beverly Willingham
Calandra Wilson
Gail Wilson
Whitney Witham
Cassandra Woodard
Kendra Woods
Thomas and Jo Ella Wright
Jackie Yager
Bleasha Young

"Give, and you will receive."

Luke 6:38a (NLT)



THE MISSION OF BAPTIST VILLAGE COMMUNITIES IS TO HONOR GOD BY CREATING COMMUNITIES AND SERVICES TO ENHANCE LIVES AND ENABLE PEOPLE TO SERVE GOD AND ONE ANOTHER.

EXECUTIVE TEAM

Home Office • 3800 N. May Avenue, Oklahoma City, OK 73112 • Toll-Free: 1.866.887.2872

Dr. William Pierce, *President*

Corky Eshelman, *Vice President - Marketing and Development*

Steve Thomas, *Vice President - Operations*

Wendell Short, *Vice President - Planning and Project Management*

Ken Mills, *Chief Financial Officer*

VILLAGES

Baptist Village of Ada • 3501 Oakridge Drive, Ada, OK 74820 • 580.332.6004

Tracy Scheer, *Campus Director*

Baptist Village of Broken Arrow • 2801 N. Birch Avenue, Broken Arrow, OK 74012 • 918.355.0099

Arvella McCollom, *Campus Director*

Baptist Village of Cleveland • 1001 Baptist Village Drive, Cleveland, OK 74020 • 918.358.2575

Terry Dennis, *Campus Director*

Baptist Village of Hugo • 1200 W. Finley Street / P.O. Drawer 608, Hugo, OK 74743 • 580.326.8383

Dan Stiles, *Campus Director*

Baptist Village Lake Texoma • 10777 Village Drive, Madill, OK 73446 • 580.564.3776

James Rosson, *Campus Director*

Baptist Village of Oklahoma City • 9700 Mashburn Boulevard, Oklahoma City, OK 73162 • 405.721.2466

Martin Hall, *Campus Director*

Michelle Billings, *Assistant Campus Director*

Chris Finley, *Director of Chaplain Services and LINC® Ministry*

Baptist Village of Okmulgee • 1500 W. 6th Street, Okmulgee, OK 74447 • 918.756.5377

Sherri Powell, *Campus Director*

Baptist Village of Owasso • 7410 N. 127th East Avenue, Owasso, OK 74055 • 918.272.2281

Nathan Purifoy, *Campus Director*

Mitzi Epperson, *Assistant Campus Director*

ENTRUSTED HEARTS BY BAPTIST VILLAGE

Shannon Ryan, *Director*

Lawton Office • 60 N.W. Sheridan Road Suite 6, Lawton, OK 73505 • 580.355.2440

Oklahoma City Office • 9700 Mashburn Boulevard, Oklahoma City, OK 73162 • 405.720.2401

Owasso/Tulsa Office • 7410 N. 127th East Avenue, Owasso, OK 74055 • Toll-Free: 1.888.272.5339

Medical Equipment • 208 E. 5th Avenue Suite H, Owasso, OK 74055 • Toll-Free: 1.877.272.6263

Case Management • 3800 N. May Avenue, Oklahoma City, OK 73112 • Toll-Free: 1.888.910.2234